

## TSL SERIES - L.W.C.O.

Low Water Cut Off sensor for  
OEM Applications

### FEATURES

- Cost effective solution for boilers and water heaters
- Uses water as conductor in combination with a suitable certified control board with LWCO function
- High Quality AISI 316 stainless steel material
- High Quality Delrin, PPX, Nylon, or Teflon insulation available
- Available with standard 1/8", 1/4", or 3/8" NPT threads and 1/4" BSP threads
- Standard Immersion lengths of 35mm or 50mm
- LWCO only or available as a multi-purpose sensor
- Integrated 1/4" fast connect tabs or Molex available in duplex sensor configuration
- CE & RoHS compliant



### GENERAL INFORMATION

High quality Low Water Cut Off sensors are available for a variety of OEM applications. When used in combination with a suitable control, these sensors utilize the water medium as a conductor to provide LWCO functionality.

Available in standard LWCO versions with immersion depths of 35mm and 50mm; or in combination with temperature measurement and/or high level limit capabilities.

Customized OEM configurations available upon request. Options include higher pressure/temperature ratings, material alternatives, connector options, as well as variable lengths and threads.

## SPECIFICATIONS

Standard Probe:	AISI 316 Stainless Steel
Isolator:	Delrin, PPX, Nylon, or Teflon
Mounting:	Direct mounting with NPT or BSP threads. Available in sizes ranging from 1/8" to 1/2".
Connection:	1/4" fast-on tabs standard on LWCO-only models; Molex available in multi-purpose sensors
Pressure Rating Max:	150 psi / 10 bar
Temperature Max:	250°F / 120°C
Approval:	CE & RoHS compliant
Warranty:	5 year limited warranty
Accessories:	Factory applied Teflon taping

## DIMENSIONS ( in mm )

T = Thread

L = Immersion Length

I = Insulator Length

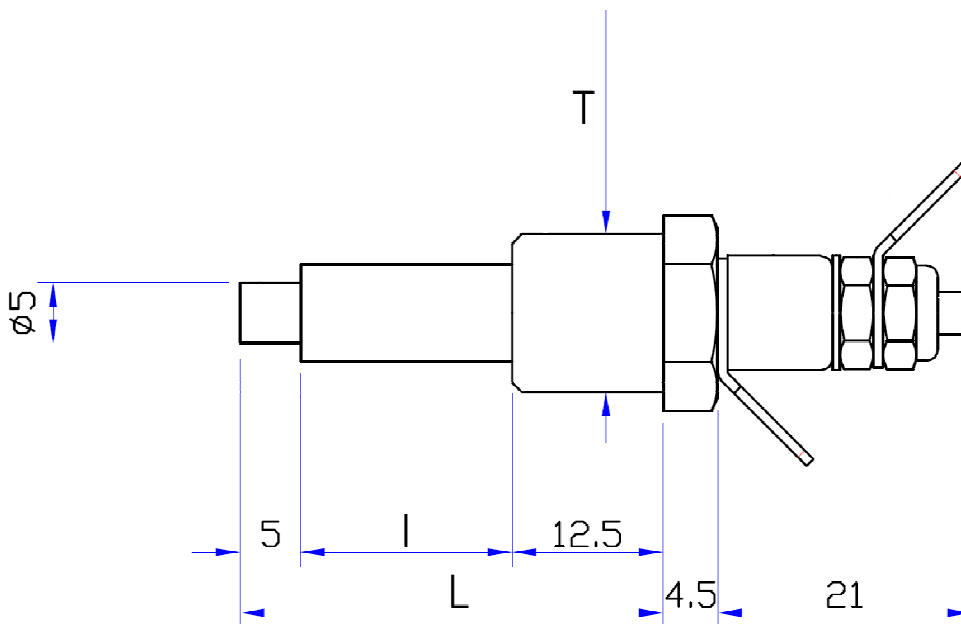

## **ORDERING INFORMATION**

Standard Part Numbers for Low Water Cut Off functionality only:

TSL035A—35mm Immersion Length / 1/4" NPT Thread / Double Tab

TSL035B—35mm Immersion Length / 1/8" NPT Thread / Double Tab

TSL035C—35mm Immersion Length / 1/4" BSP Thread / Double Tab

TSL035D—35mm Immersion Length / 1/4" NPT Thread / Single Tab

TSL035E—35mm Immersion Length / 1/8" NPT Thread / Single Tab

TSL050A—50mm Immersion Length / 1/4" NPT Thread / Single Tab

TSL050B—50mm Immersion Length / 1/8" NPT Thread / Double Tab

TSL050C—50mm Immersion Length / 3/8" NPT Thread / Single Tab

TSL050D—50mm Immersion Length / 3/8" NPT Thread / Double Tab

**Please call for information on models with duplex and triplex sensor functionality.**

**Tasseron Sensors Inc.**

140 Choate Circle

Montoursville, PA 17754

Tel: +1 (570) 601-1971

Fax: +1 (570) 601-1972

Email: [sales@tasseronusa.com](mailto:sales@tasseronusa.com)